

# MAIN FLOOR

1091 SQ. FT.

9'-0" CEILING HEIGHT

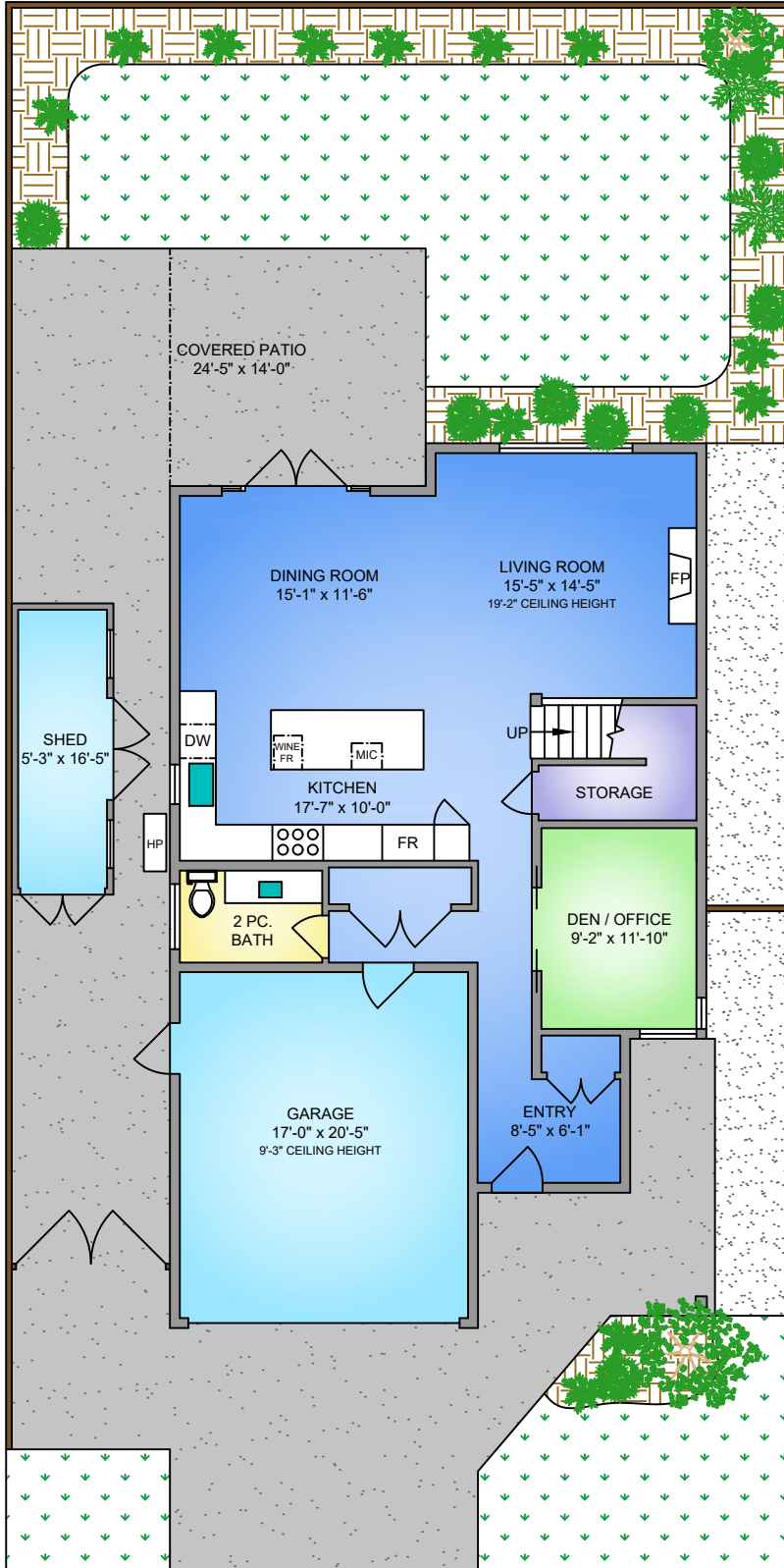

# UPPER FLOOR

1209 SQ. FT.

9'-0" CEILING HEIGHT

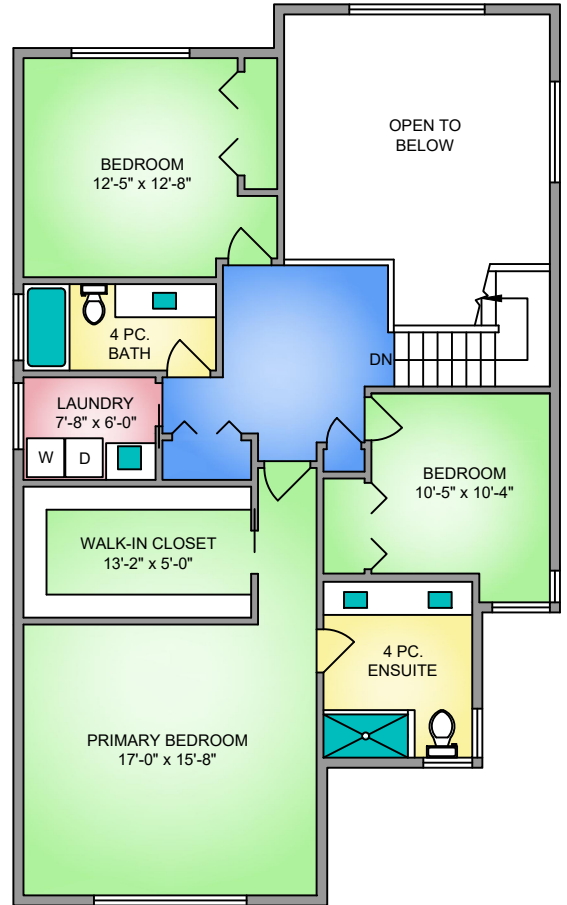

NORTH

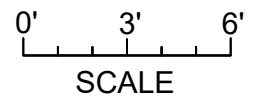
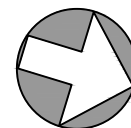

9262 RIDEAU AVENUE MAY 7, 2024			
PREPARED FOR THE EXCLUSIVE USE OF MODERN REAL ESTATE TEAM PLANS MAY NOT BE 100% ACCURATE, IF CRITICAL BUYER TO VERIFY.			
FLOOR	AREA (SQ. FT.)		
	FINISHED	GARAGE	DECK / PATIO
MAIN	1091	370	406
UPPER	1209	-	-
<b>TOTAL</b>	<b>2300</b>	<b>370</b>	<b>406</b>